

ESC 电调

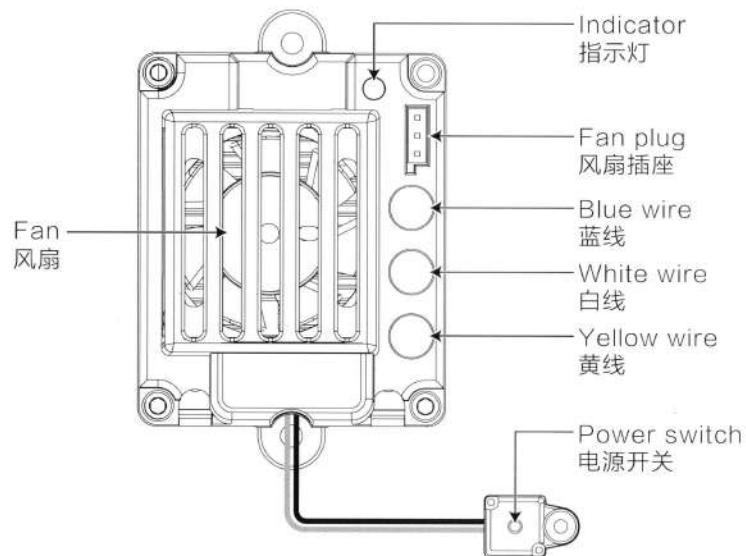

Indicator light situation 指示灯状态	Meanings 含义
Stays on 常亮	Signaled 有信号
Flash quickly 快闪	a. No signal 无信号 b. Pull the trigger 扣动扳机
Flash slowly 慢闪	Low voltage 低电压
Flash twice 闪两下	Over heat protection 过热保护
Off 熄灭	Stuck protection 堵转保护

Chinese User Only



SNAIL ESC



中国内地用户

International User



Google play



App Store

ESC can be connected by Smartphone to read parameters and set up. Please scan the QR code to download APP.
ESC can be connected with APP under power-on condition. Please make sure the Bluetooth of your cell phone is turned on before connecting.
ESC可通过手机连接读取参数并设置。请下载APP。
电调通电状态下即可与APP连接。连接前请确保手机蓝牙已打开。

T3B Transmitter 遥控器

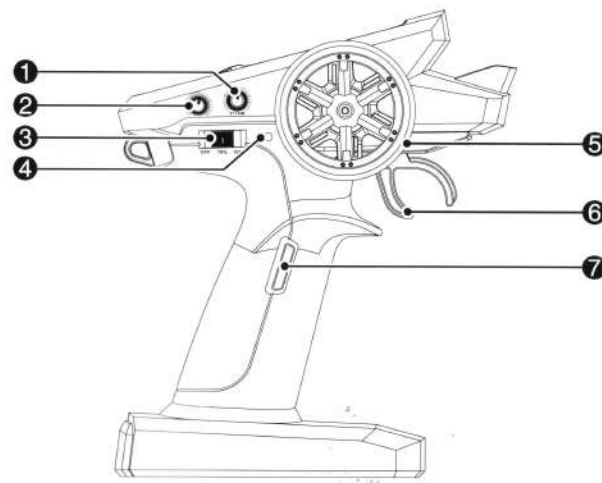

- ① ST.TRIM (Steering servo trimmer)
ST.TRIM (转向舵机微调)
- ② TH.TRIM (Throttle trimmer)
TH.TRIM (油门中位微调)
- ③ Power switch
电源开关
(OFF-70%TH-100%TH)
- ④ Indicator light
指示灯
- ⑤ CH1: ST (Steering)
CH1: ST (转向)
- ⑥ CH2: TH (Throttle)
CH2: TH (油门)
- ⑦ Fn (CH3 Light control)
Fn (CH3灯控)

① ST.TRIM (Steering servo trimmer 转向舵机微调)

If the car cannot go straightly during driving, it can be adjusted through the ST.TRIM. 车辆行驶过程中如无法直线行驶，可通过此微调进行调整。

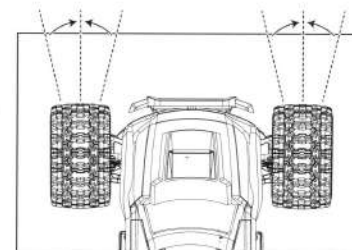

② TH.TRIM (Throttle trimmer 油门中位微调)

If the car can't be stop when the TH in the middle place, you can adjust the button to stop the car. 如TH (油门) 在中位状态下，车辆无法正常停止，可通过此微调进行调节，使车辆停止。

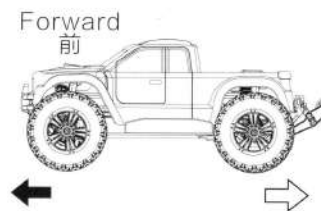

③ Power/Speed switch 电源/速度档位开关

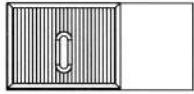

OFF 70% 100%

OFF 70% 100%
(关) (70% Throttle) (100% Throttle)
(70%油门) (100%油门)

④ Indicator light 指示灯

Stays on 常亮	Working well 正常
Flash quickly 快闪	Frequency mating 对码状态
Flash slowly 慢闪	Low battery of transmitter 遥控器电量低

⑦ Fn (CH3 Light control 灯控)

Short Press the “Fn” button to turn on/off the light of high speed car.
短按“Fn”按键时，控制高速车灯光开启或关闭。



⑤ CH1: ST (Steering 转向)

Middle
中位

Turn left
左转

Turn right
右转

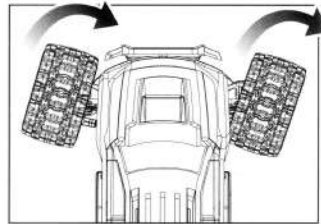
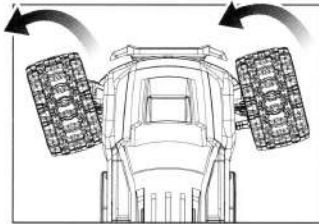
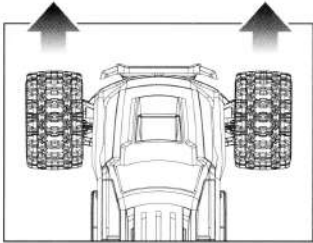
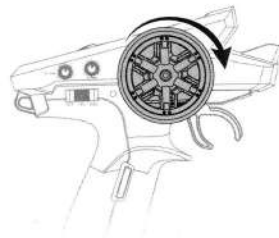
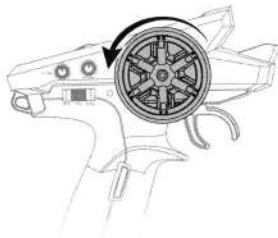
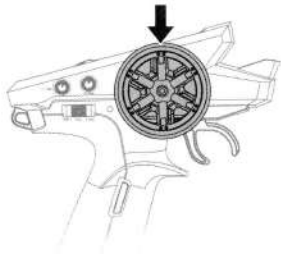

⑥ CH2: TH (Throttle 油门)

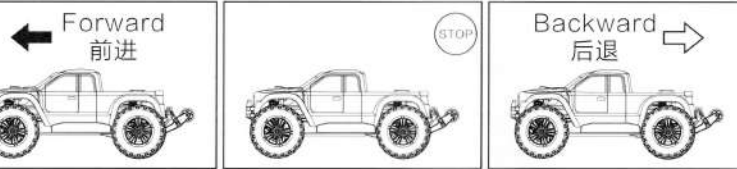
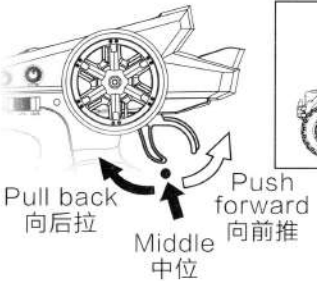

Brake: When the car is going forward, pull the transmitter trigger back, and the car enters into the braking state. After the trigger is in the middle, push back again, and the car can move backward.

刹车：当车辆向前行驶时，遥控器推动后退，车辆进入刹车状态，需油门归中后，再次推动后退，车辆才能后退。

*When the car is in reverse situation, it does not the brake function.

Install the Transmitter's Battery 遥控器安装电池

Open the transmitter's battery cover, insert 2 AA batteries according to the indicated positive and negative direction, close the battery cover.
将遥控器电池盖打开，按照遥控器指示的正负极，正确装入2节AA电池，再重新盖上电池盖。

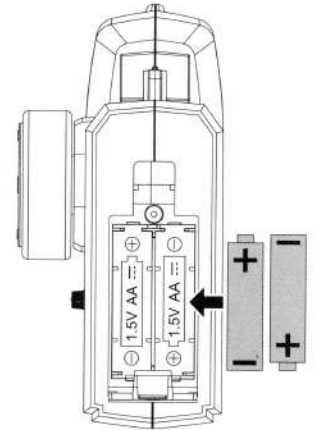
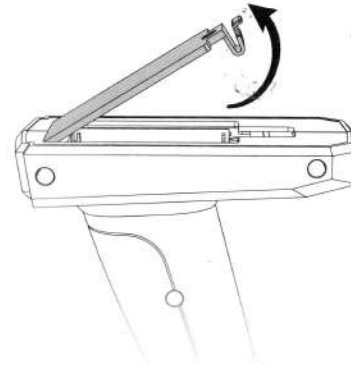

Install the Head Wheels 抬头轮安装

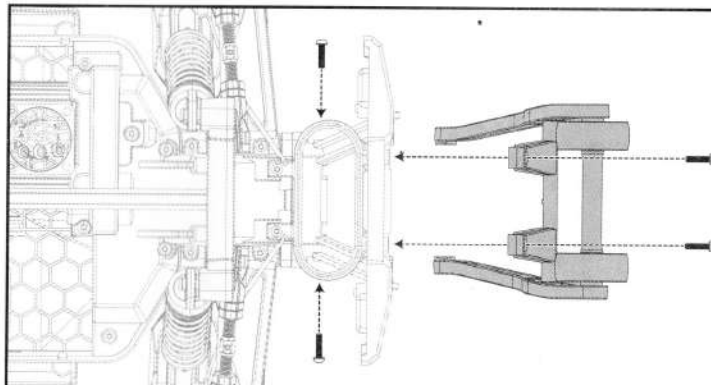

Fix the head wheels into the rear of the car via 4 screws.
将抬头轮架用4颗螺丝固定在车身尾部。

- ① Tighten the battery with the fixing tape; 将固定带绑紧电池;
- ② Connect the receiver plug to the battery. 将接收器插头连接电池。

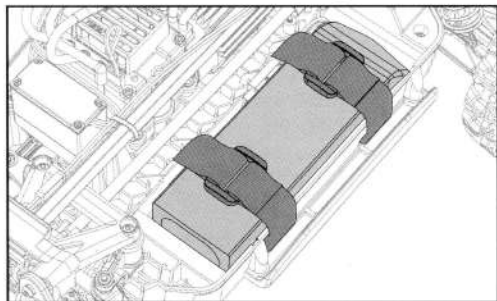

①

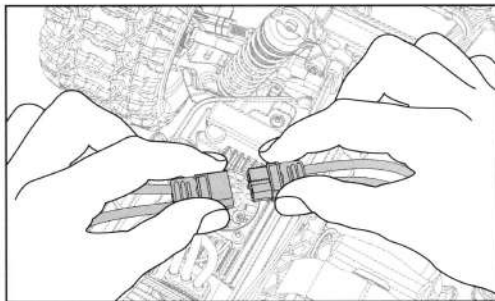

②

Install Car Shell 安装车壳

1. Insert the body into the front mount ① and press the latch vertically down to the rear mount ②.

将车壳插入前固定件①，锁扣垂直下压到后固定件②。

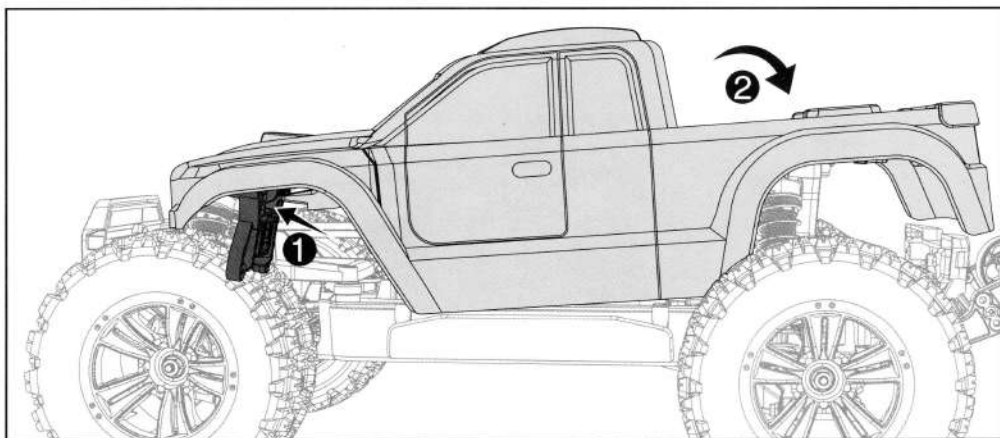

2. Slide the latch to lock the body. 扳动锁扣锁紧车壳。

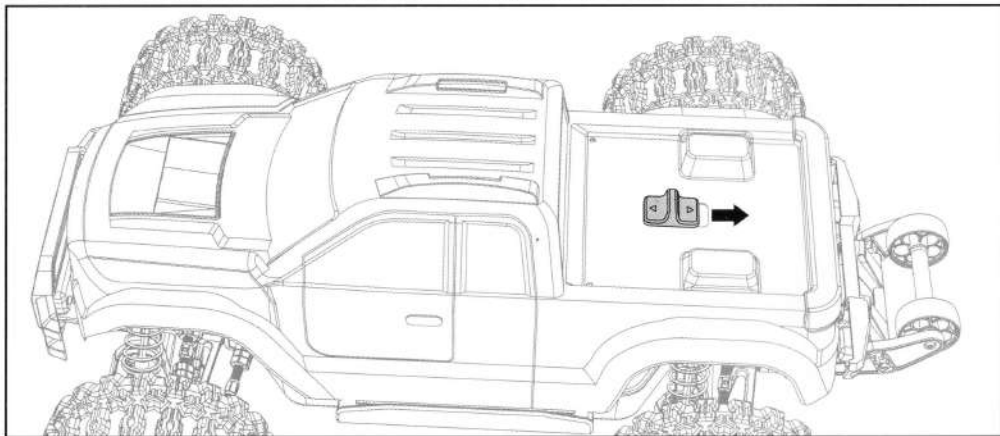

Screw 螺丝:

HTM3010 $\varnothing 3 \times 10 \text{mm}$ 6PCS

Screws 螺丝

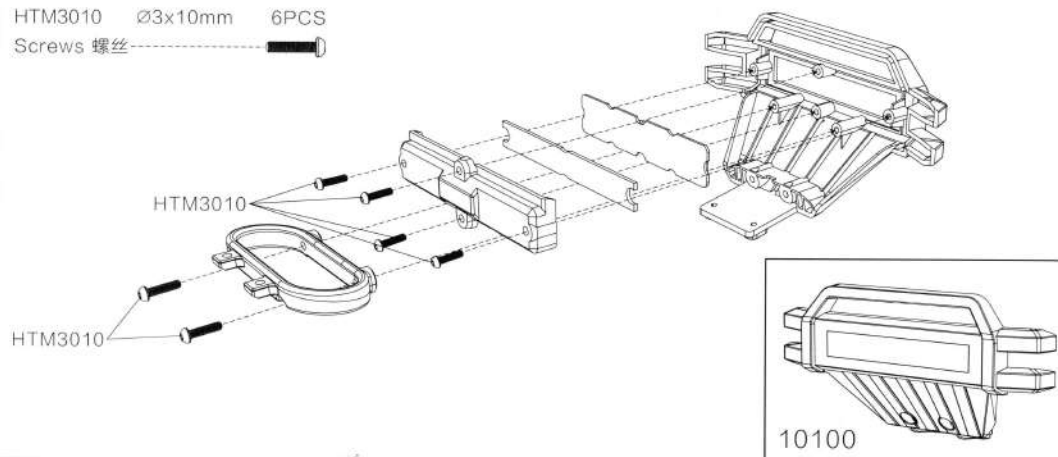

Rear Bumper Assembly 后防撞组件

Screw 螺丝:

HTM3010 $\varnothing 3 \times 10 \text{mm}$ 4PCS

Screws 螺丝

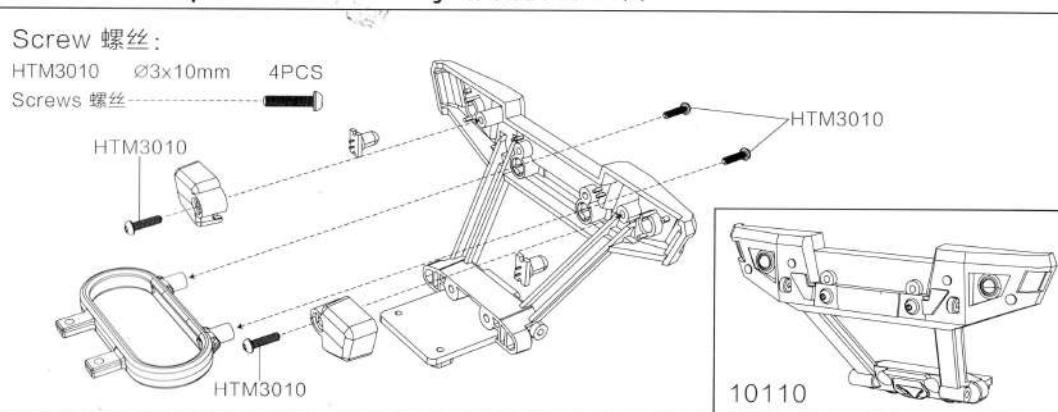

Front Swing Set 前摆臂组件

Screw 螺丝:

HTM3016 $\varnothing 3 \times 16 \text{mm}$ 1PCS

Screws 螺丝

HTHM30135 $\varnothing 3 \times 13.5 \text{mm}$ 2PCS

Screws 螺丝

HTHM3049 $\varnothing 3 \times 49 \text{mm}$ 1PCS

Screws 螺丝

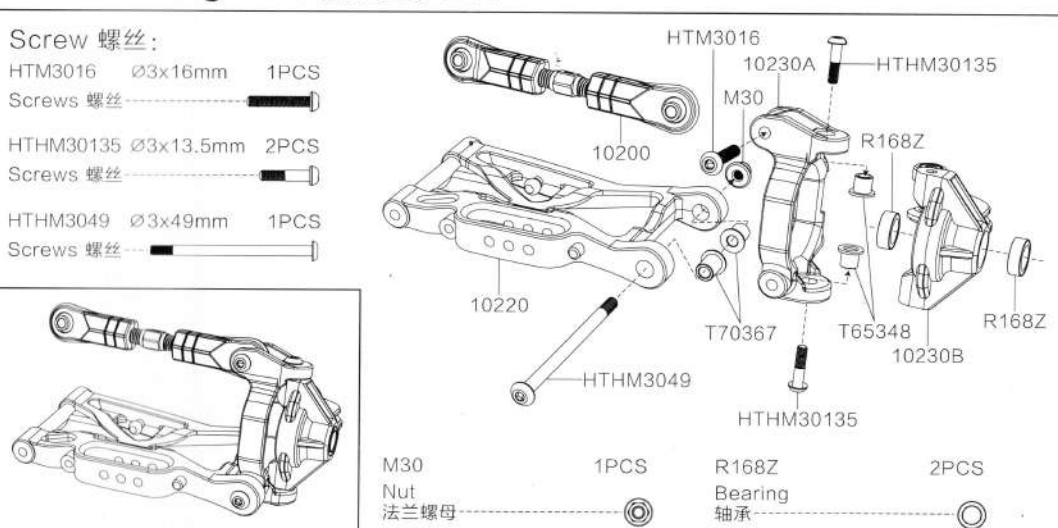

M30

Nut 法兰螺母

1PCS

R168Z
Bearing 轴承

2PCS

Screw 螺丝:
 HTM3016 $\varnothing 3 \times 16 \text{mm}$ 1PCS
 Screws 螺丝

HTHM3040 $\varnothing 3 \times 40 \text{mm}$ 1PCS
 Screws 螺丝

M30 Nut 法兰螺母 1PCS

R168Z Bearing 轴承 2PCS

Front/Rear Sway Bar 前/后防倾杆

Screw 螺丝:
 M3030 $\varnothing 3 \times 3 \text{mm}$ 2PCS(4PCS)
 Screws 内六角机丝螺丝

Front 前

Rear 后

Screw 螺丝:
 HTM3016 $\varnothing 3 \times 16 \text{mm}$ 6PCS
 Screws 螺丝

HTM3010 $\varnothing 3 \times 10 \text{mm}$ 2PCS
 Screws 螺丝

HWM4030 $\varnothing 4 \times 3 \text{mm}$ 1PCS
 Screws 内六角机丝螺丝

⚠️
 When using a 4S (14.8V) battery to drive the car, make sure that both fans are connected to the receiver and operating properly.
 当使用4S(14.8V)电池驱动车辆时候, 请务必保证2个风扇均已连接接收机, 并能正常运行。

Oil Filled Shock 油压避震

3000cs Silicone Oil 硅油

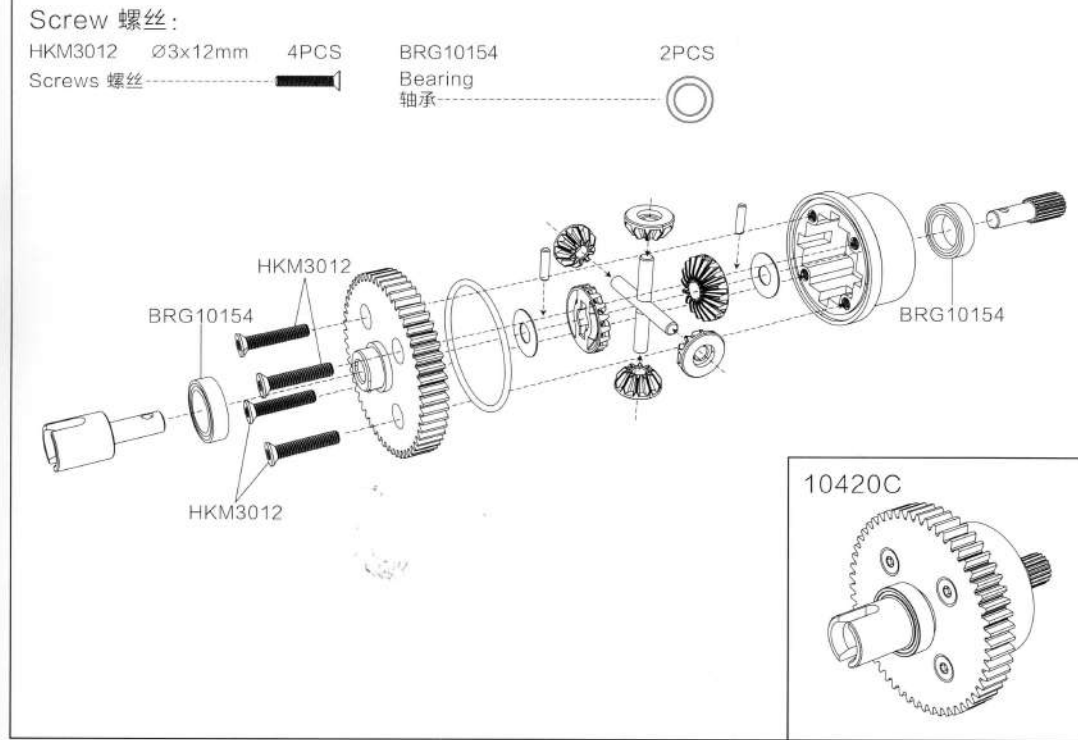
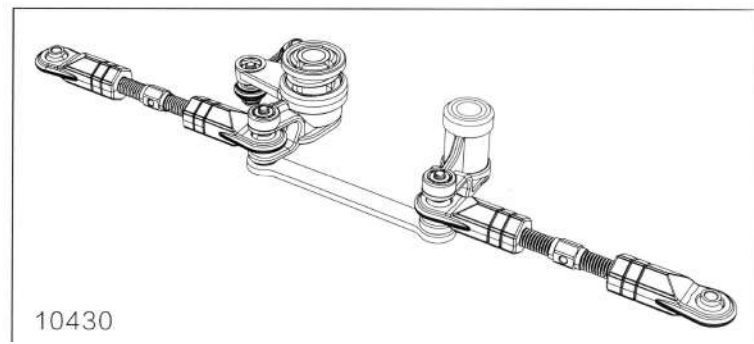
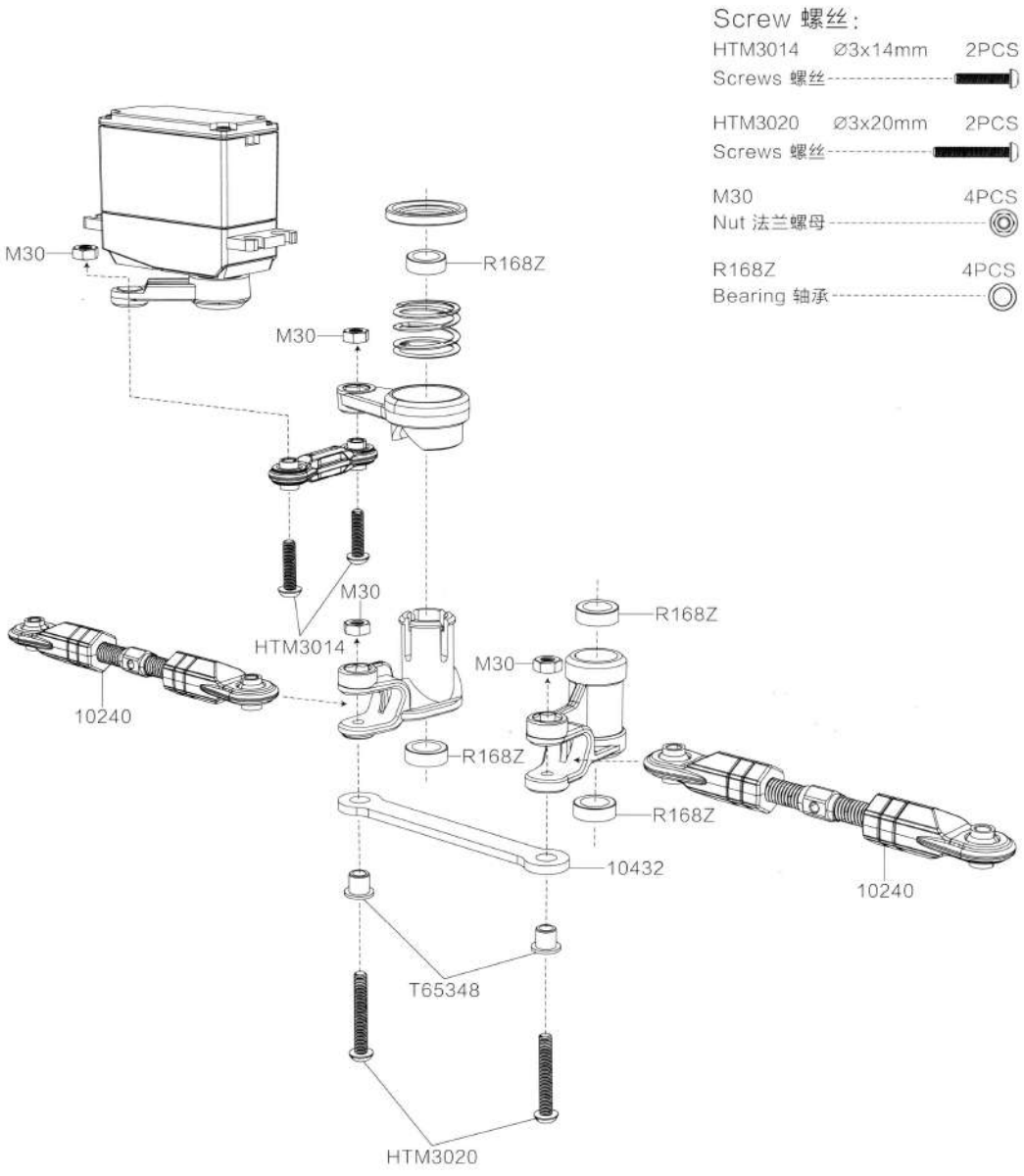

Front/Rear Differential 前/后差速器

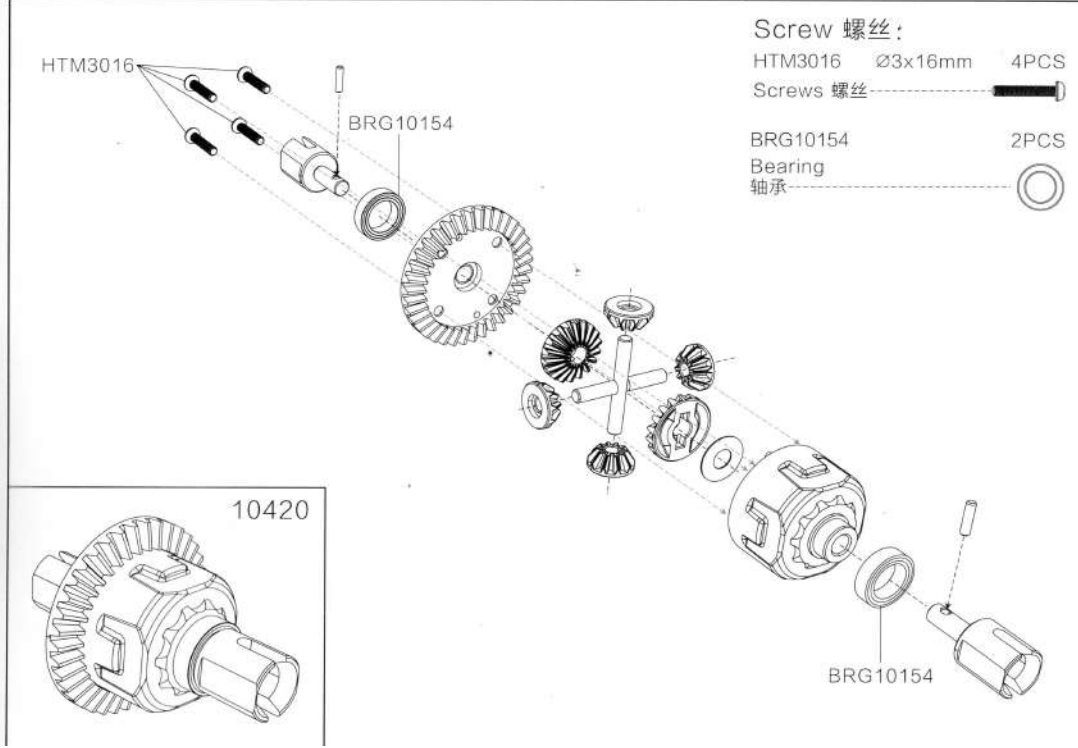

Screw 螺丝:

HTM3012 $\varnothing 3 \times 12 \text{mm}$ 2PCS

Screws 螺丝

HKM3080 $\varnothing 3 \times 8 \text{mm}$ 1PCS

Screws 螺丝

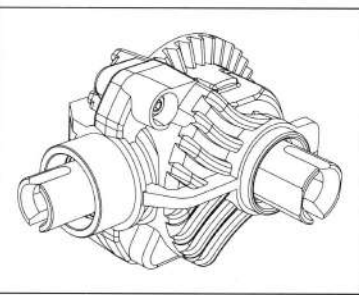
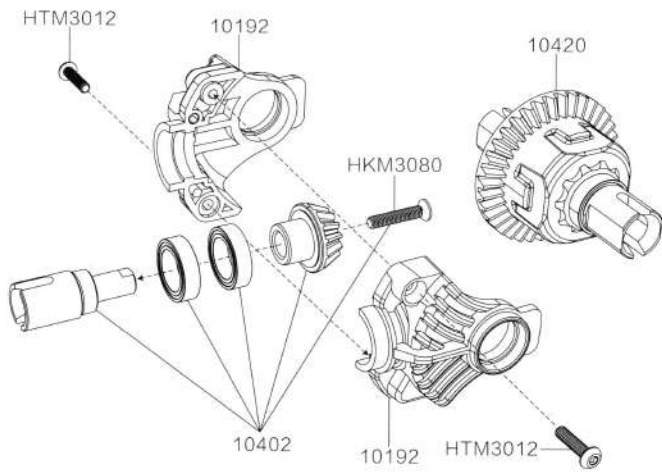

Rear Gearbox 后齿轮箱

Screw 螺丝:

HTM3012 $\varnothing 3 \times 12 \text{mm}$ 2PCS

Screws 螺丝

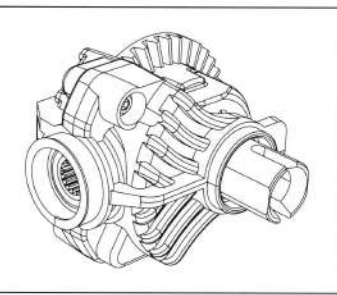
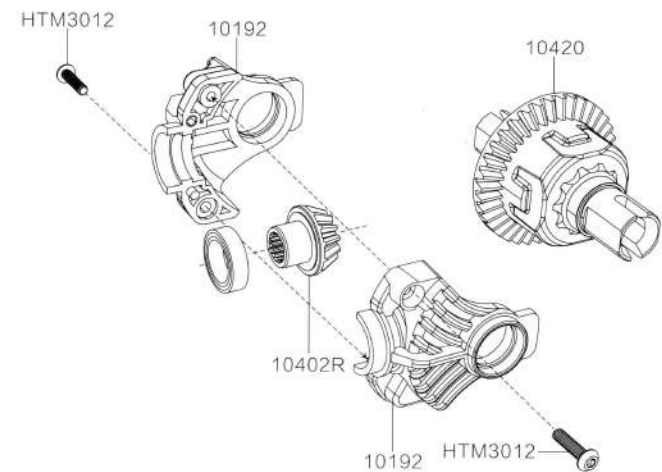

Servo Assembly 舵机组件

Screw 螺丝:

M3080 $\varnothing 3 \times 8 \text{mm}$ 1PCS

Screws 螺丝

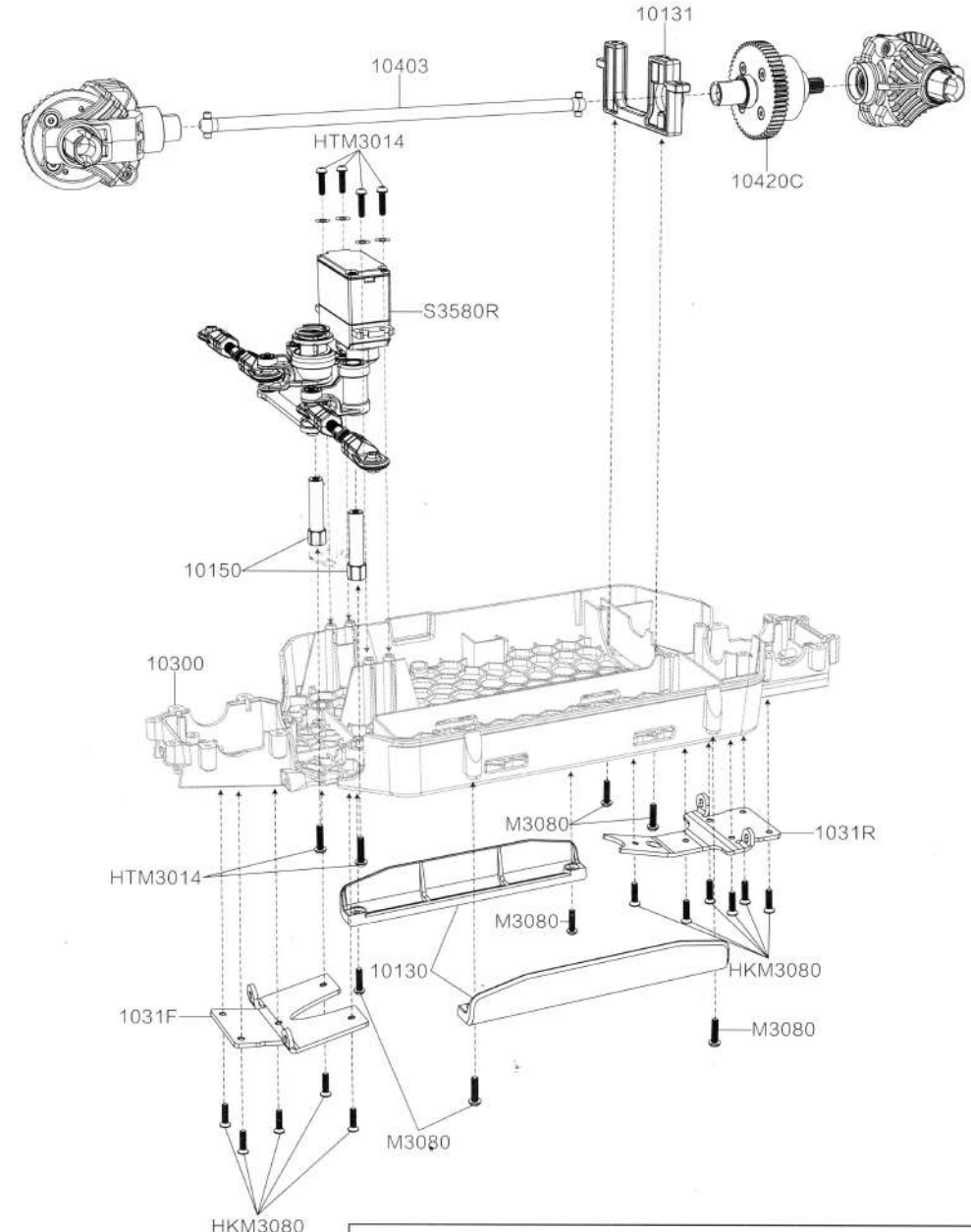
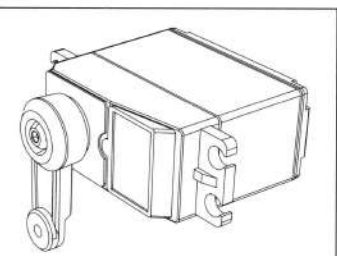
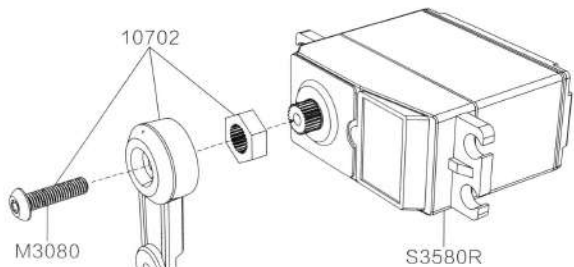

Screw 螺丝:

HTM3014 $\varnothing 3 \times 14 \text{mm}$ 6PCS

Screws 螺丝

M3080 $\varnothing 3 \times 8 \text{mm}$ 6PCS

Screws 螺丝

HKM3080 $\varnothing 3 \times 8 \text{mm}$ 11PCS

Screws 螺丝

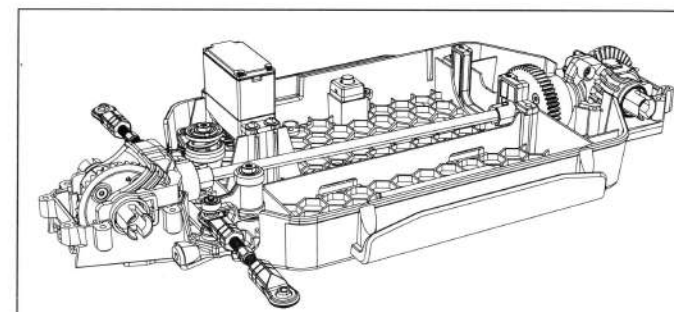

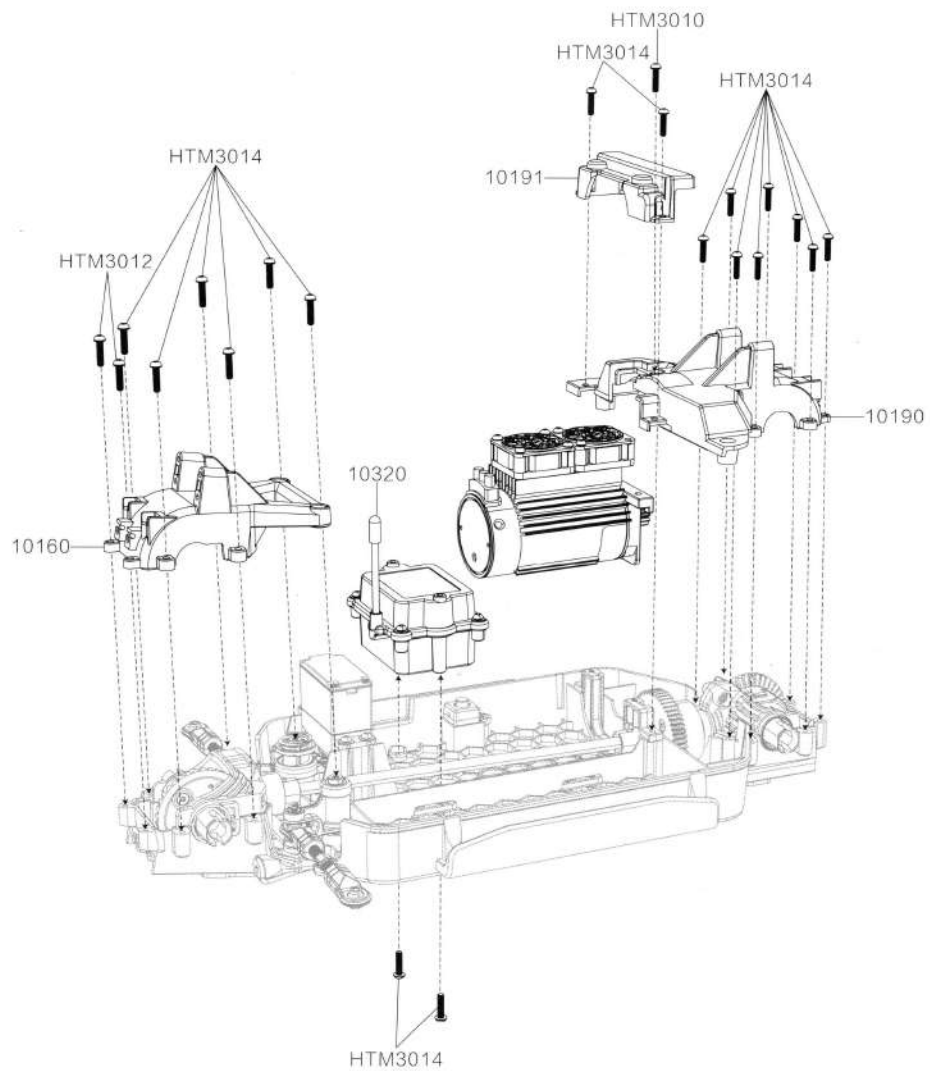

Screw 螺丝:

- | | | |
|-----------|---------|---|
| HTM3014 | ∅3x14mm | 18PCS |
| Screws 螺丝 | ----- |  |
| HTM3012 | ∅3x12mm | 2PCS |
| Screws 螺丝 | ----- |  |
| HTM3010 | ∅3x10mm | 1PCS |
| Screws 螺丝 | ----- |  |

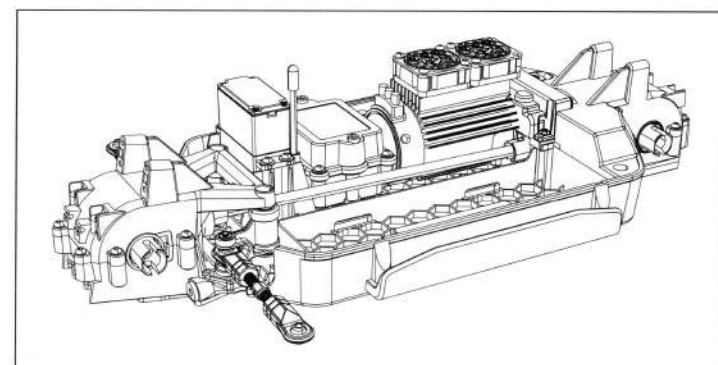

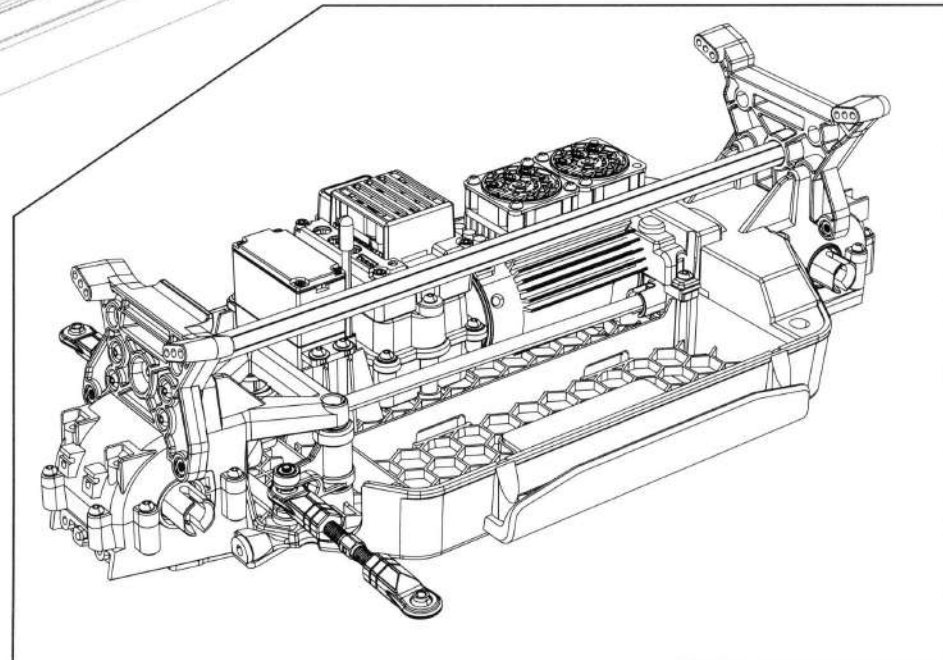
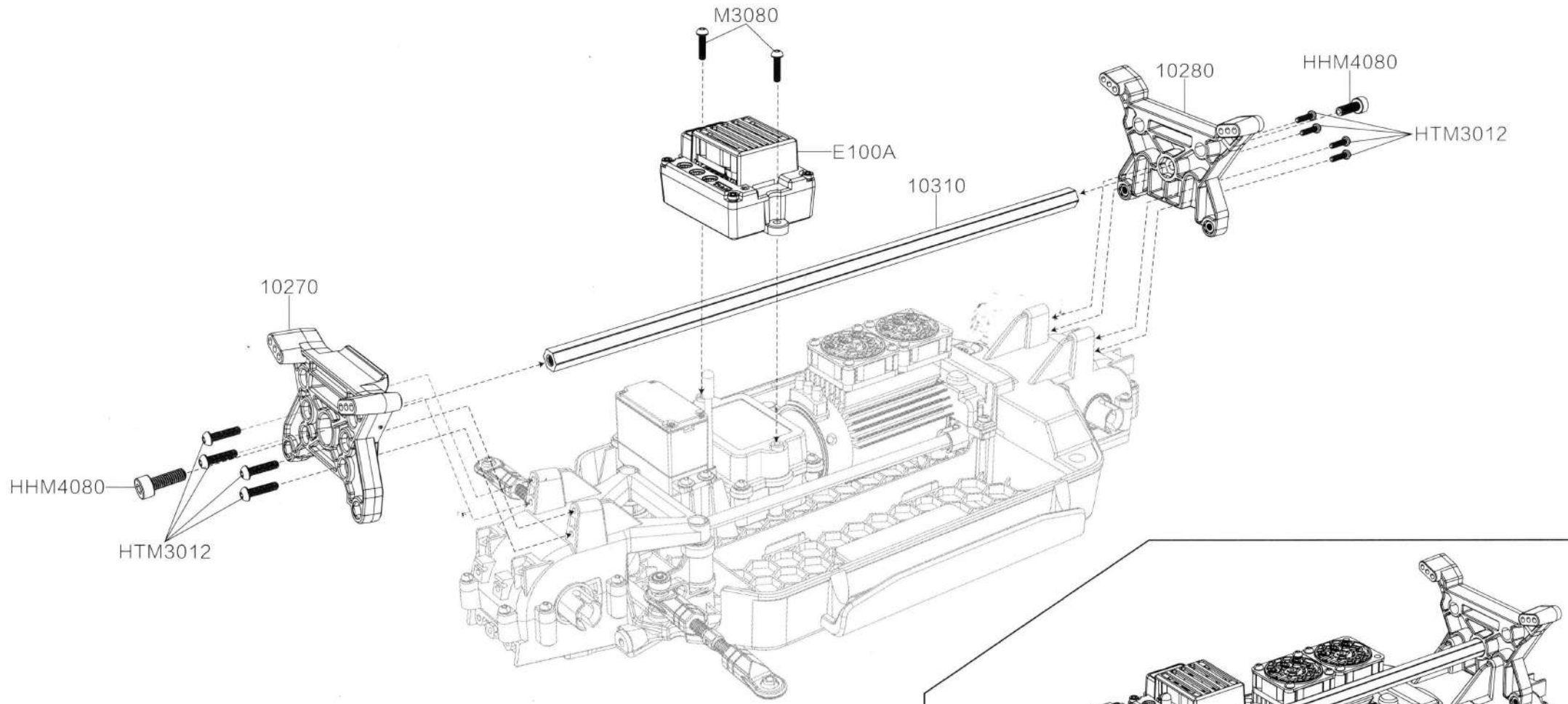

Screw 螺丝:

HTM3012 $\varnothing 3 \times 12 \text{mm}$ 8PCS

Screws 螺丝 ----- 

M3080 $\varnothing 3 \times 8 \text{mm}$ 2PCS

Screws 螺丝 ----- 

HMM4080 $\varnothing 4 \times 8 \text{mm}$ 2PCS

Screws 螺丝 ----- 

Screw 螺丝:

HTM3016 $\varnothing 3 \times 16 \text{mm}$ 3PCS(6PCS)

Screws 螺丝

HTM3014 $\varnothing 3 \times 14 \text{mm}$ 2PCS

Screws 螺丝

HTM3060 $\varnothing 3 \times 6 \text{mm}$ 4PCS

Screws 螺丝

M30 1PCS(2PCS)

Nut 法兰螺母

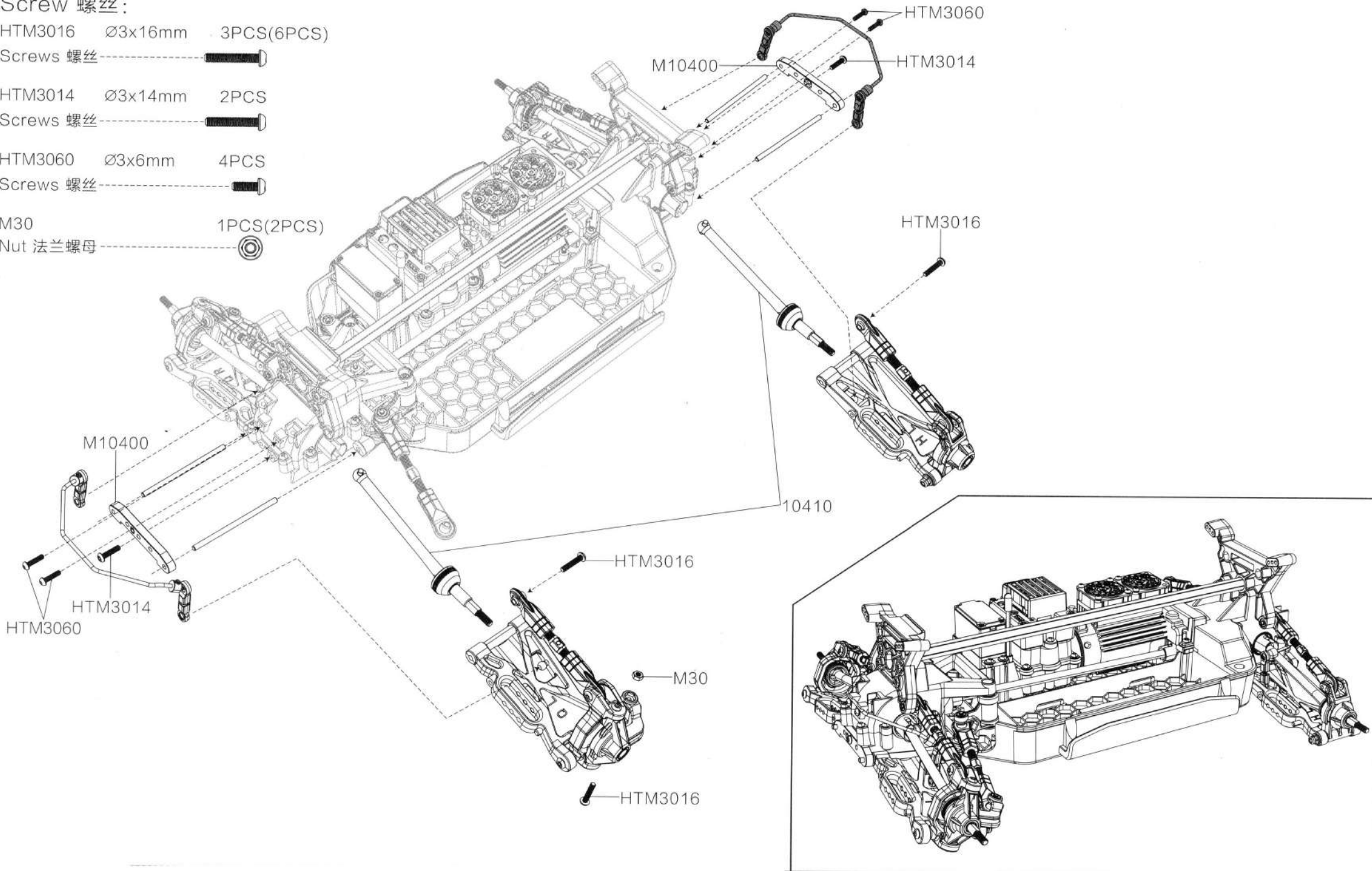

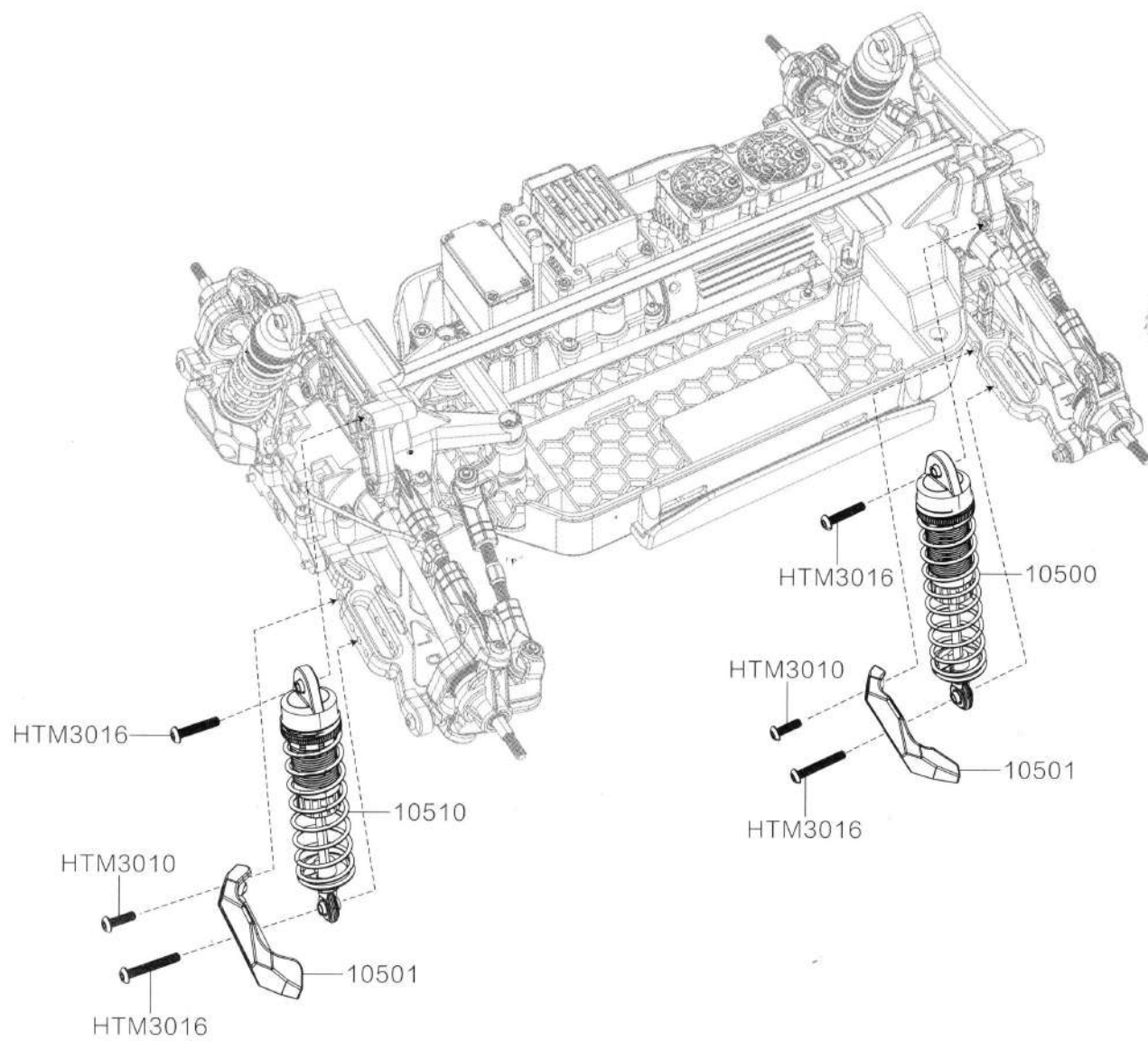

Screw 螺丝:

HTM3016 $\varnothing 3 \times 16 \text{mm}$ 4PCS

Screws 螺丝

HTM3010 $\varnothing 3 \times 10 \text{mm}$ 2PCS

Screws 螺丝

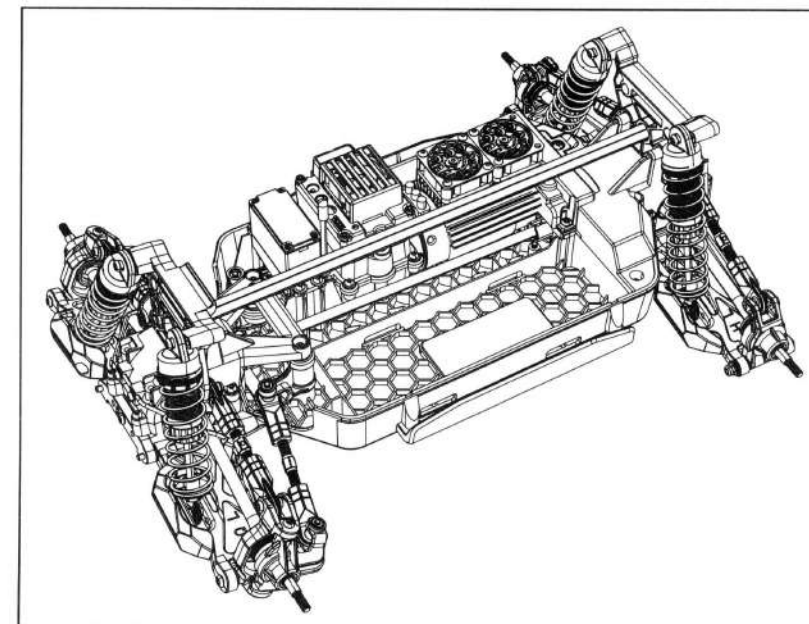

Screw 螺丝:

HTM3014 $\varnothing 3 \times 14 \text{mm}$ 8PCS

Screws 螺丝 

HTM3010 $\varnothing 3 \times 10 \text{mm}$ 4PCS

Screws 螺丝 

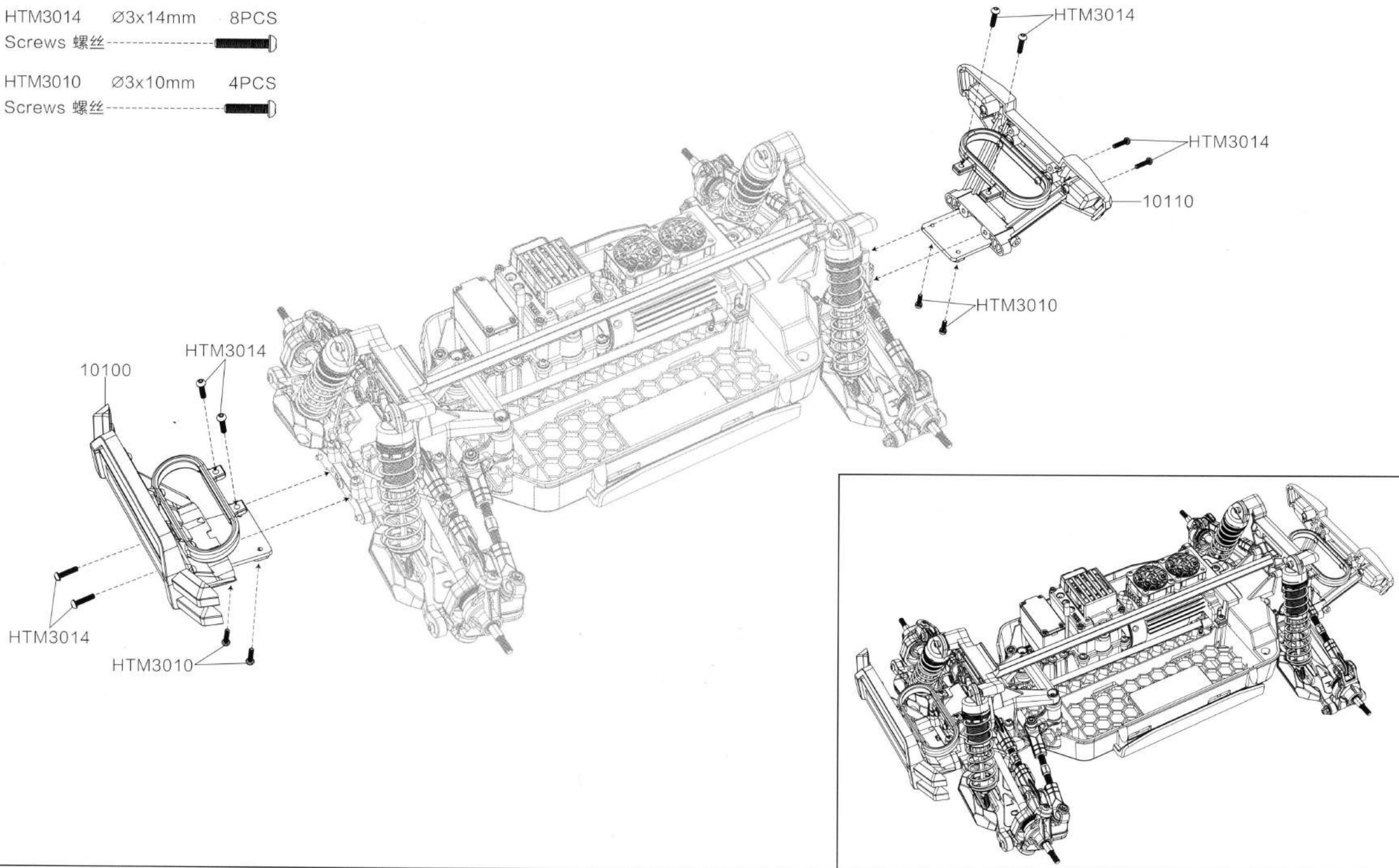

Nut 螺母:

M40 1PCS (4PCS)

M4 Wheel lock nut

M4螺母

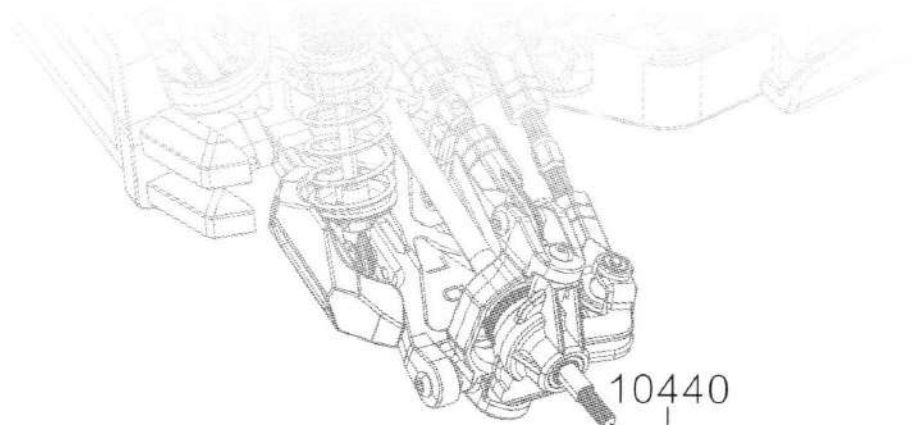

10440

10440

1015A

M40

